

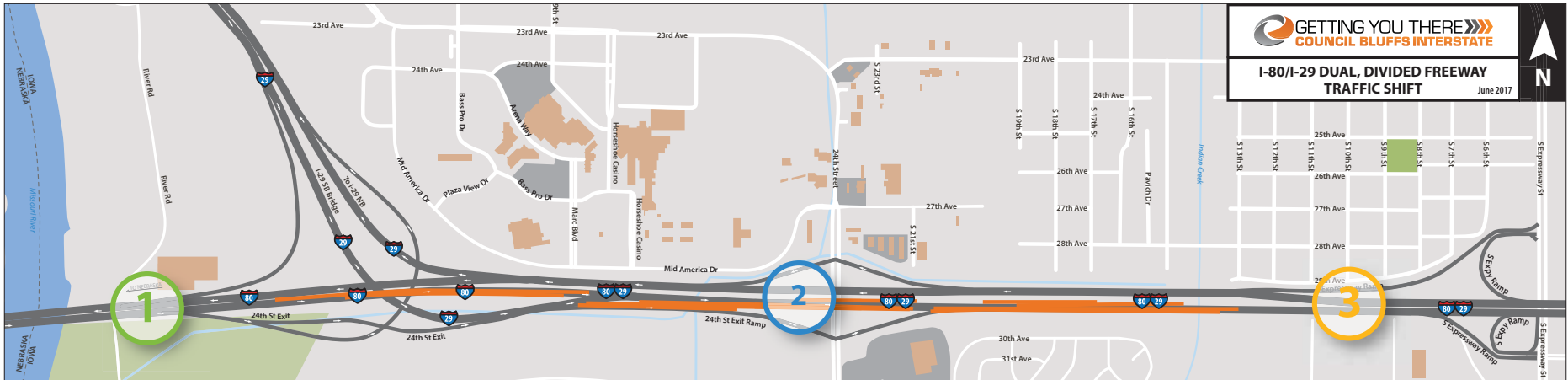

I-29/I-80 DUAL, DIVIDED FREEWAY TRAFFIC SHIFT 2017 CONSTRUCTION AND TRAFFIC MOVEMENTS



1

I-80 EASTBOUND

I-80 traffic will use newly constructed lanes located north of existing lanes.

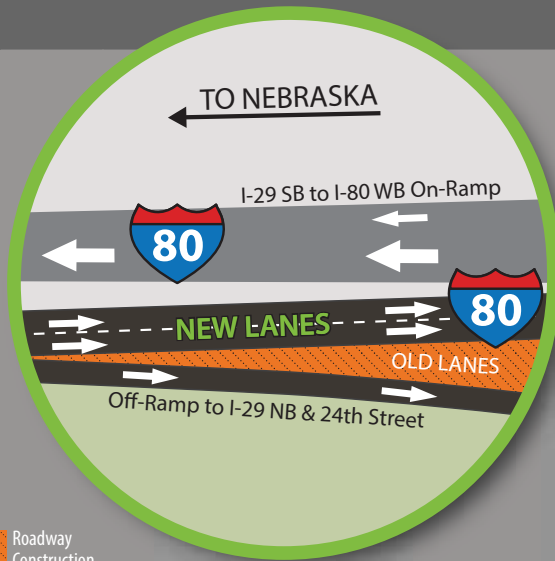

2

24TH STREET ON-RAMPS

The I-29 southbound ramp will join I-80 eastbound at a new temporary location.

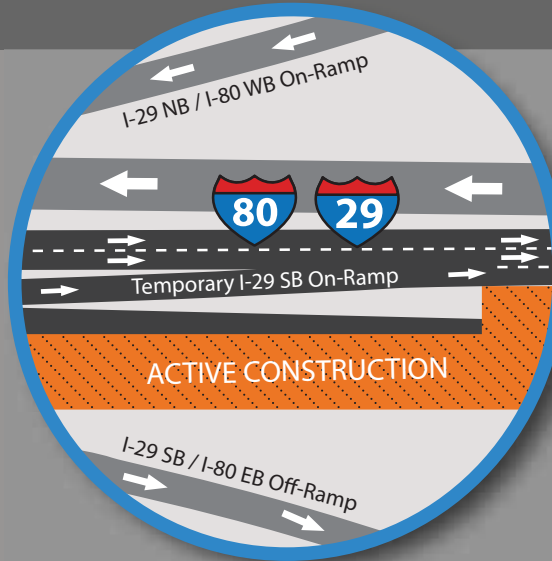

3

I-80 EASTBOUND/I-29 SOUTHBOUND

Interstate traffic will shift back to existing lanes just west of South Expressway (Exit 3).

