

EAST SYSTEM INTERCHANGE/MADISON AVE TRAFFIC SHIFTS

2018 CONSTRUCTION AND TRAFFIC MOVEMENTS

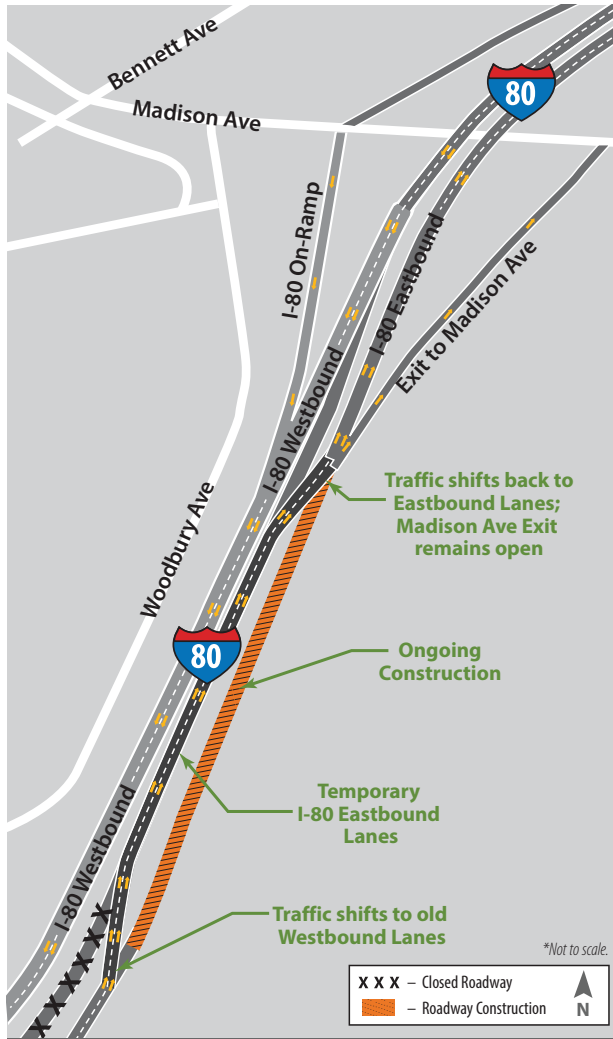

1 APRIL: I-80 EASTBOUND TRAFFIC SHIFT
Beginning in April, I-80 Eastbound traffic will shift to the old I-80 Westbound lanes for a short distance. The Madison Avenue Exit will remain open.

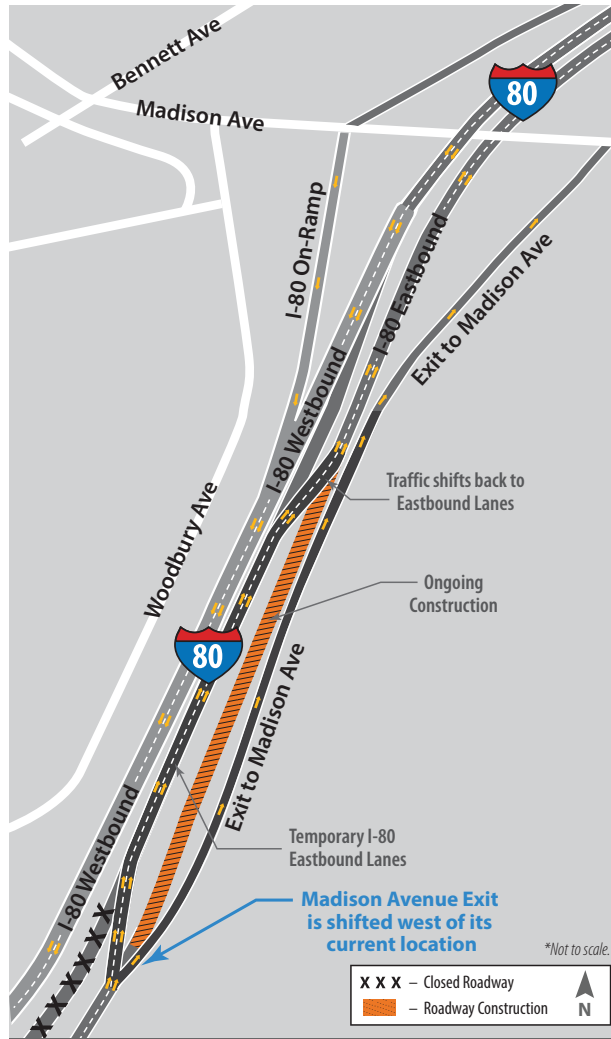

2 OCTOBER: MADISON AVENUE EXIT RAMP
In October 2018, the Madison Avenue Exit will move west of its current location. I-80 Eastbound traffic continues using temporary (old I-80 Westbound) lanes.

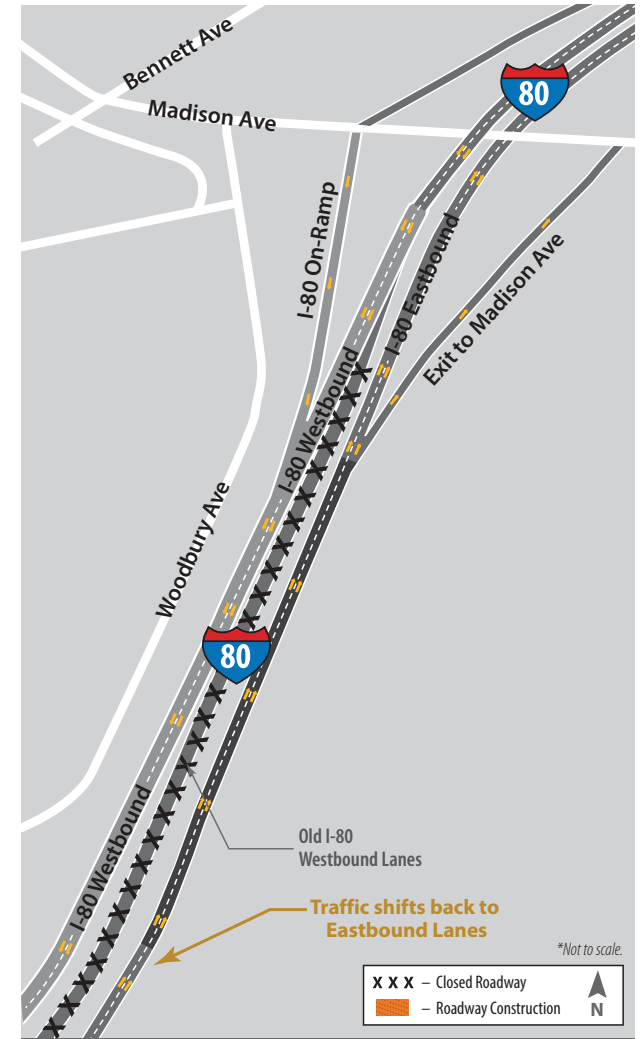

3 DECEMBER: MADISON AVENUE EXIT RAMP
In December 2018, I-80 Eastbound traffic will shift from the old I-80 Westbound lanes, back to the I-80 Eastbound lanes. Construction will continue the following spring.