



PRESS RELEASE

Contact:
Scott Suhr
712.216.3339
info@CouncilBluffsInterstate.com

U.S. 275/ Iowa 92 Interchange Northbound On and Off Ramps to Close for Approximately One Year

(Council Bluffs, IA – April 10, 2015) – The I-29 northbound on and off ramps at the U.S. 275/ Iowa 92 Interchange (Exit 47) are expected to close for approximately one year beginning on Thursday, April 16. Motorists will need to follow the marked detour to the South Expressway/Iowa 192 exit/on ramp (Exit 3). Denmark Drive into Metro Crossing will also close from approximately April through September 2015; Metro Drive will remain open throughout construction.

Traffic has been reduced to one lane in each direction on U.S. 275/Iowa 92 since June 2014 to allow for reconstruction of the new westbound bridges and adjoining pavement. In September 2015, U.S. 275/Iowa 92 traffic will move from the eastbound lanes to the newly-finished westbound lanes. I-29 may have one or two overnight closures near the interchange to remove the existing U.S. 275/Iowa 92 eastbound bridge after the traffic shifts to westbound lanes. Detours will be posted and drivers will be notified in advance.

Iowa DOT is in the process of reconstructing I-80, I-29 and I-480 in the Council Bluffs metropolitan area. This comprehensive interstate redesign will modernize the highway system and improve mobility and safety of approximately 18 miles of interstate. Motorists are encouraged to allow for extra travel time while this interstate improvement takes effect. If you would like more information about detours and traffic impacts visit the program website, www.CouncilBluffsInterstate.IowaDOT.gov.

Contact: Scott Suhr, Iowa DOT Transportation Planner at 712.326.3712 or info@CouncilBluffsInterstate.com.

[Attachments: U.S. 275 Traffic Movements Map and Detour Map]

#

I-29 AND U.S. 275/IOWA 92 INTERCHANGE 2015 CONSTRUCTION AND TRAFFIC MOVEMENTS

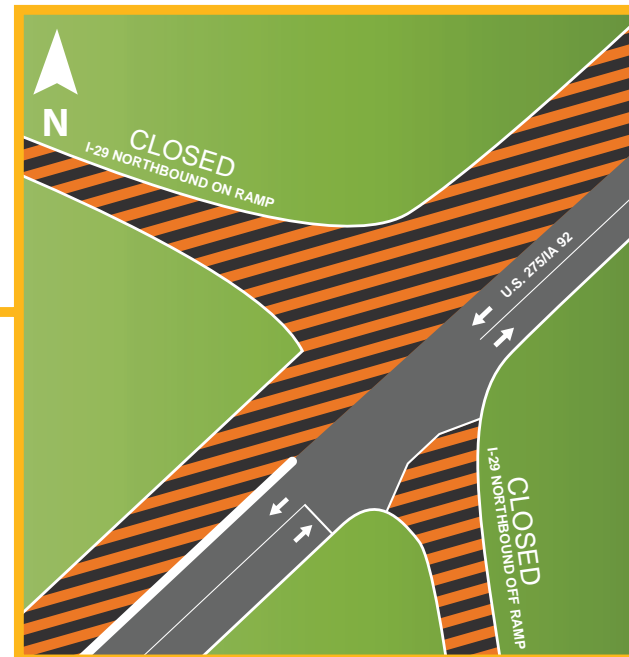

- » Iowa 92 traffic continues to be one lane in each direction.
- » Beginning April 2015, ramps to and from I-29 northbound from U.S. 275/Iowa 92 will close for approximately one year.



- » Denmark Drive will be closed from approximately April through September 2015.
- » The next change to occur in 2015 begins in September, when U.S. 275/Iowa 92 traffic moves from the eastbound lanes to the newly finished westbound lanes. Denmark Drive will open at this time.

I-29 AND U.S. 275/IOWA 92 INTERCHANGE

2015 DETOUR

